

# INSTRUCTION MANUAL THIS MODEL IS NOT A TOY!

THESE INSTRUCTIONS SHOULD BE READ BY A SUPERVISING ADULT

## MAD SHARK V3 RTR MINI EP F1 SPEED BOAT

ITEM NO. 8203V3

### CONTENTS OF SET

- |   |   |
|---|---|
| 1) MAD SHARK V3 RTR MINI EP F1 SPEED BOAT | 5) Boat Stand                           |
| 2) Transmitter                            | 6) 4pcs AA batteries(for transmitter)   |
| 3) 7.4V Power Pack                        | 7) 2.5mm Allen Key(For pushrod tighten) |
| 4) 2S USB balance charger                 | 2.0mm Allen Key (for Grub Screws)       |
|   | 8) Radio hanger & screws                |

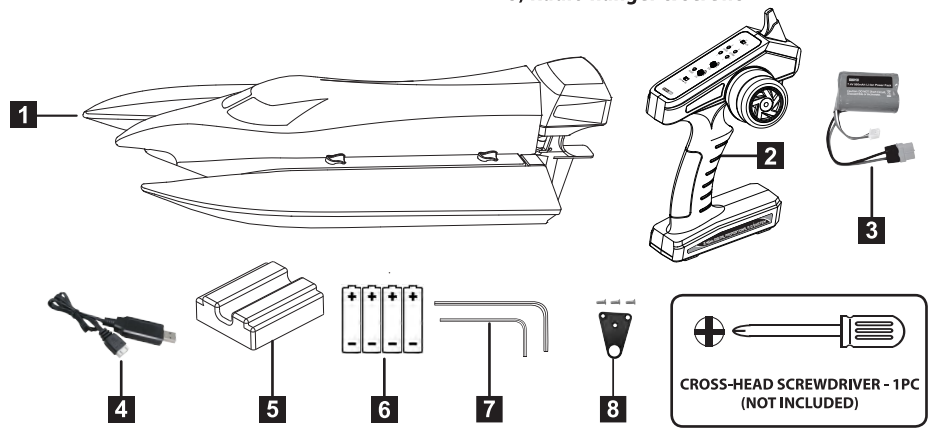

### Caution for Li-Ion battery:

ESC with low voltage protection, as soon as you notice boat speed slow down obviously, you should drive the boat back to shore and recharge battery. Do not keep playing the boat when ESC low voltage protection active, otherwise, battery will be over discharged and might be damaged and won't be recharged again.

### Caution:

1. Continuous running of the model will generate high heat levels, Which will lead to premature wear of the motor. Once your power pack is exhausted, we recommend that you open model's upper deck and let motor air cool for around 15 minutes before installing a fresh power pack. This action will protect motor and extend its working life.

2. Before racing your model boat, carefully check silicone tube for guarantee good water cooling system; Avoid water inlet on the bottom of hull become deformed, otherwise, water cooling system failure, this may lead to ESC burned out and motor defected.

### IMPORTANT

The Mad Shark is designed for use in fresh water only. It is not designed for use in salt water!  
The Mad Shark is not intended for persons under 14 years of age, unless closely supervised by an adult.

## INSTALLING TRANSMITTER BATTERIES

**NOTE:** The transmitter is not water resistant and should never come in contact with water.

1. Install four fresh "AA" batteries. Follow the diagram located in the bottom of the battery tray for proper battery orientation
2. Switch on transmitter, transmitter make sound "Bi", LED power light will be flashing.

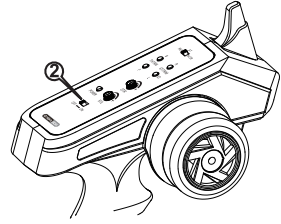
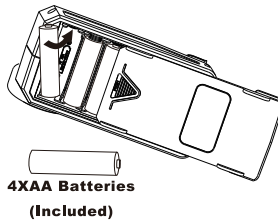

## RADIO HANGER

Triangle radio hanger and 3pcs screw are included in tool bag, use these to hang radio on your neck with ribbon.



## CHARGING THE 7.4V POWER PACK

- 1) Connect USB balance charger with USB port of computer equipment, mobile phone adapter or power bank. USB charger RED light solid on.
- 2) Connect battery's charging plug with USB charger's charging port. USB charger RED light solid on, GREEN light flash, this indicate that the battery is charging.
- 3) A fully discharged battery will take about 4 hours to be fully charged. Do not leave the battery unattended while charging.
- 4) The RED light turn to be off, GREEN light turn to be solid on when the charge is completed. Disconnect the 7.4V battery from the charger.



**NOTE:** Around 1.5 hours battery charging time, Battery can be charged around 80% capacity, then USB balance charger will continue to charge battery with low charging current, need around 3 hours, USB charger GREEN light turn to be solid on, means battery now is fully charged.

### CAUTION:

- 1) The 7.4V battery does not come pre-charged. You must fully charge the battery before using the boat
- 1) The 7.4V battery can be re-charged many times before it needs to be replaced. When the battery no longer holds a charge (is dead), it should be properly recycled.

**NOTE 1:** The boat will run for about 8 mins on a fully charged battery. As soon as you notice a drop off in speed, you should bring the model back to shore to recharge battery or you may lose control of the boat.

**NOTE 2:** Continuous running of the model will generate high heat levels, which will lead to premature wear on the motor. It is recommended to let the model cool down for about 5-10 min before installing a re-charged battery pack.

## INSTALLING THE 7.4V POWER PACK IN THE MAD SHARK

1. Always switch on transmitter before connecting the battery with ESC.
2. firstly rotate the plastic lock underneath the boat head, then rotate the four plastic lock at the hatch as photo show to remove the hatch.

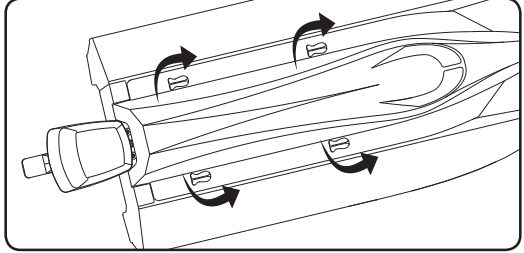
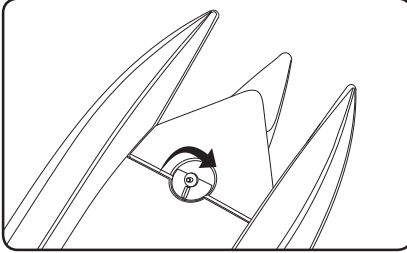

3. Place the boat hull on the polyfoam boat stand
4. Fix the charged finished battery inside the hull.
5. Attach battery connector to the matching connector of ESC.
6. Re-position hatch by rotating plastic locks at the hatch firstly, then rotate the plastic lock underneath the boat head.

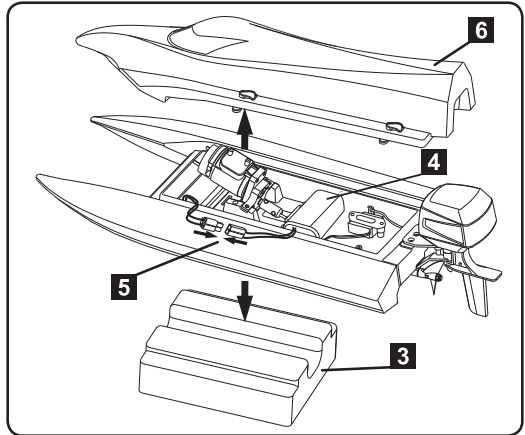

**NOTE:** 1. There is a water proof rubber ring placed inside the slot of hull, always make sure it's secured positioned before re-position the hatch.

## TRANSMITTER/RECEIVER BINDING

transmitter and receiver are automatically binding once they are power on. No need to press any bind button. Just make sure no other transmitter or receiver should be powered on near by.

- 1) Switch on transmitter, transmitter make sound "Bi", LED power light will be flashing.
- 2) Connect battery with boat's ESC, transmitter make sound "Bi Bi", LED power light turn to solid on, now transmitter have automatically bind with boat.

## CHECKING THE RADIO SYSTEM

1. Always switch on the transmitter before connecting the battery with the ESC.

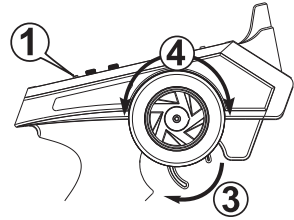

2. Connect battery with boat's ESC

3. Pull the throttle & motor rotate in anticlockwise direction, your motor is now armed and ready for operation.

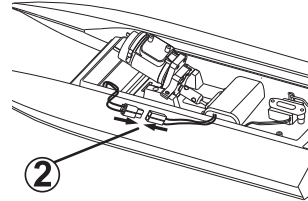

4. Check the direction of the rudder, the trailing edge of the rudder should turn right when right input is given, Conversely, when left input is given, the trailing edge of the rudder should turn left.

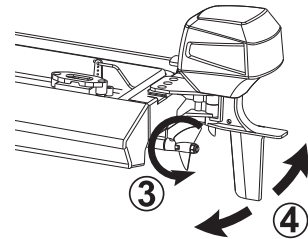

**NOTE:** The left and right steering angle are pre-set as standard angle to suitable for common boat driving style. If you want to change the turning radius, you can adjust the two knobs on transmitter "ST/R", "ST/L". more detail information refer to "EPA ADJUSTMENT".

## DRIVING YOUR BOAT

- 1) Switch on transmitter, transmitter power LED light flash.
- 2) Check that the Warrior's turn fins are adjusted correctly.
- 3) Switch 'ON' the boat (connect the 7.4V Power Pack).
- 4) Check that the propeller and the rudder respond to transmitter inputs before placing the Boat on the water.

### AFTER USE

- 1) When you have finished using your Boat, you should first switch 'OFF' the model (disconnect the 7.4V Power Pack), then switch 'OFF' your transmitter.
- 2) Remove all batteries from the transmitter and model.
- 3) Leave the Boat's upper deck off to allow moisture to evaporate. Ideally, place the model in this way in a warm and dry place, like an airing cupboard, until you are sure it is dry and then store it away.

**NOTE:** If the Boat begins to bob when running, it may have taken on an excessive amount of water. In this case, you should immediately return to shore, remove the upper deck and drain the water from the hull.

## TRANSMITTER INTRODUCTION

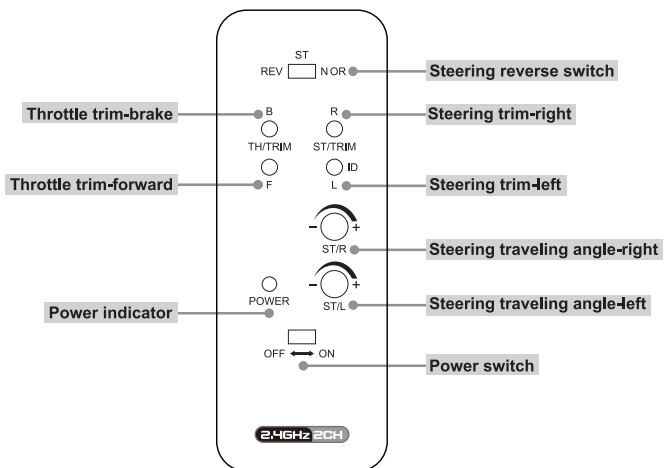

## EPA ADJUSTMENT

### Function

Use this when performing left and right steering angle adjustments. End Point Adjustment (EPA) adjusting value range: 0%-100%

### Setting

1. Steering (right side) angle adjustment Rotate "ST/R" knob to the left end point means minimum value 0%, right end point means maximum value 100%.
2. Steering (left side) angle adjustment Rotate "ST/L" knob to the left end point means minimum value 0%, right end point means maximum value 100%.

### CAUTION:

When adjusting this function, make sure the direction is in agreement with the boat direction, you can adjust by the STEERING "REV-NOR" button.

### Steering reverse switch

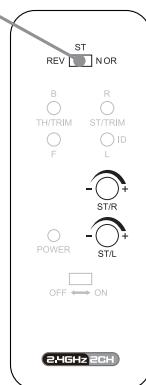
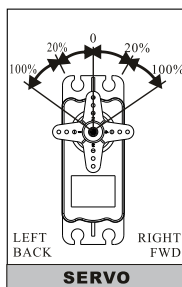

## TRIM ADJUSTMENT

### Steering trim

Adjust "ST/TRIM" "R/L" so that rudder is centered prior to operation, you may adjust this control to make the boat run straight during operation.

### CAUTION:

When adjusting steering trim, make sure the direction is in agreement with the boat direction, you can adjust by the STEERING "REV-NOR" button.

### Throttle trim

Adjust "TH/TRIM" "B/F" to stop propeller from turning while the throttle trigger is in the neutral position.

### Steering reverse switch

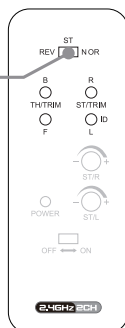

## LUBRICATING DRIVE SHAFT

Lubricating the flexshaft is vital to the life of the drivetrain. The lubricant also acts as a water seal, keeping water from entering the hull through the stuffing tube. Lubricating the flexshaft, propeller shaft after every 2 or 3 times of operation.

1. Use the 2mm Allen key to loose the two grub screws of the coupler which connects the flexshaft, then slide the flexshaft w/ prop shaft out of the stuffing tube.
2. Lubricate the flexshaft w/ prop shaft with the water proof marine grease, reinstall the flexshaft w/ prop shaft in reverse order, be sure to retighten the two grub screws of coupler.

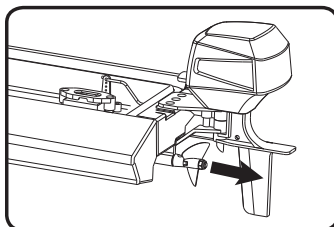
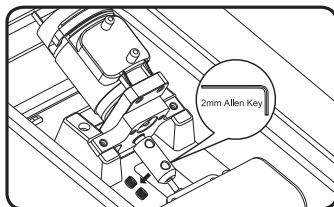

## CAUTION!

**Please observe the following warnings. DURING OPERATION**

- The transmitter's range will vary depending on your surroundings and battery strength. Do not operate Mad Shark too far away or control will be lost.
- Ensure that all batteries are correctly installed and that the 7.4V Power Pack is fully charged.
- Do not operate your Mad Shark in areas with strong currents, in salt water or areas of water with large waves.
- Do not touch moving parts during operation, especially the propeller.
- Do not let your Mad Shark run aground, as this can cause damage.
- If you lose control of your Mad Shark, never wade into deep water or water with strong currents to retrieve it. First, hold the transmitter as high as you can to try to re-establish control. If this does not work, find another way to move closer to the model, but do not endanger yourself in the process!

## GENERAL INFORMATION FOR THE SAFE OPERATION OF YOUR MAD SHARK

**Please follow these simple rules to ensure safe operation and gain the maximum enjoyment from your model.**

- Avoid overloading your model. Never run it in areas where its movement will be restricted, e.g. areas where there is pond weed, etc., as this can over stress the motor.
- Ensure nothing prevents the smooth running of moving parts.
- Do not run your model in confined spaces.
- Never run your model in a public space where it might upset or endanger people or wildlife.
- Immediately switch 'OFF' your model and transmitter if you see lightning or hear thunder. Never use your model in the rain.

Do not dismantle or tamper in any way with this R/C vehicle and its transmitter. The manufacturer and distributor will accept no responsibility, expressed or implied, for accidents or injuries caused as a result of disassembly, modification and/or usage against the Instructions for this product.

Tampering or modification will also invalidate the guarantee.

## TROUBLE SHOOTING

Check using the chart below before returning your Mad Shark for repair as many problems can be easily solved.

PROBLEM	CAUSE	REMEDY
Model will not move	No battery in transmitter/model Battery installation is incorrect Weak battery in transmitter Weak batteries in model	Install batteries Install batteries correctly Install a fresh battery Recharge 7.4V Power Pack
No control of model	Weak battery in transmitter	Install a fresh battery
Limited radio range	Weak battery in transmitter	Install a fresh battery

## SPARE PARTS

PART NO.	DESCRIPTION
82019	7.4V 800mAH Li-ion with XT60 plug
82034	Aluminium alloy coupler w/3 screws
82053	Flex shaft set for Mad Shark brushed
82054	Scale outboard engine and rudder set-Mad Shark brushed
82055	Gear box set without metal gear
82058	Deck plastic lock set
820301	390 motor with metal gear
820303	9g rudder servo (235mm wire)
820305	Servo plastic mount with screws
820306	2S USB balance charger
820331	Mad shark deck(yellow) & gasket with plastic lock set
820506	P1.4X35mm $\Phi$ 3.0mm two blade nylon propeller (PK2)
810608	J2C96 2.4GHz 2CH transmitter
820602	ESC & receiver combo set



[www.Joysway-Hobby.com](http://www.Joysway-Hobby.com)



JOYSWAY HOBBY INTERNATIONAL LTD.

ALL RIGHTS RESERVED.

#### FCC REQUIREMENT



This device complies with Part 15 of the FCC Rules. Operation is subject to the following two conditions: (1) This device may not cause harmful interference, and (2) This device must accept any interference received, including interference that may cause undesired operation.

CAUTION: Changes or modifications to this product not expressly approved by the party responsible for compliance may void the user's authority to operate the equipment.